

IMPORTANT TO BE READ

- Copyright of this drawing is reserved by BRH Architecture and Engineering
 - All construction methods, materials, installations to be in accordance with all building regulations and codes of practice at the time of construction.
 - All sub-contractors are ultimately responsible for ensuring compliance with regulations within their own trade.
 - The user of this drawing shall cross-check dimensions shown on this drawing with relevant dimensions shown on other drawings issued by BRH Architecture and Engineering and by other design consultants relevant to the project prior to any fabrication or construction on site. All errors, omissions and discovered inconsistencies to be reported to the BRH Architecture and Engineering immediately.
 - All trades to check dimensions on site prior to fabrication.
 - Drawings show design intent only.
 - Do not scale dimensions from the drawing.
 - This drawing should not be reproduced without written prior consent from the copyright owner.
 - This drawing is specific to the job outlined in the title box below.

- APARTMENT BLOCK NO. 1 / 3 Storey over Basemnt**
 = 15 x 2 Bed Apt. @ 78.8 to 84.32 sq.m.
- APARTMENT BLOCK NO. 2 / 3 Storey over Basemnt**
 = 15 x 2 Bed Apt. @ 78.8 to 84.3 sq.m.
- 4 Bed / 7 Person / 3 Storey Split Level Houses**
 = 1 x Type 1G(i) @ 162.1 sq.m.
 = 8 x Type 1G @ 162.1 sq.m.
- 4 Bed / 7 Person / 2 Storey Houses**
 = 8 x Type 2C @ 116.5 sq.m.
 = 6 x Type 3B @ 116.5 sq.m.
 = 3 x Type 3B(i) @ 116.5 sq.m.
- 3 Bed / 5 Person / 2 Storey Houses**
 = 4 x Type 1B @ 101.7 sq.m.
 = 3 x Type 1B(i) @ 102.4 sq.m.
 = 1 x Type 1A @ 113.2 sq.m.
 = 4 x Type 1C @ 108.2 sq.m.
 = 5 x Type 1D @ 108 sq.m.
 = 8 x Type 2A @ 111.7 sq.m.
 = 8 x Type 3A @ 114.3 sq.m.
 = 5 x Type 4C @ 111.7 sq.m.
 = 1 x Type 4C(i) @ 111.5 sq.m.
- 3 Bed / 5 Person / 2.5 Storey Houses**
 = 4 x Type 1F @ 125.3 sq.m.
 = 8 x Type 1E @ 125.3 sq.m.
 = 4 x Type 4B @ 114.7 sq.m.
 = 8 x Type 4A @ 114.7 sq.m.
- 3 Bed / 4 Person / 2 Storey Houses**
 = 8 x Type 2B @ 89.7 sq.m.
- 2 Bed / 4 Person / 2 Storey Houses**
 = 2 x Type 2F @ 88 sq.m.
 = 3 x Type 2D @ 80 sq.m.
 = 3 x Type 3C @ 80 sq.m.
- 1 Bed / 2 Person / Apt. / 2 Storey**
 = 4 x Type 2E @ 53.4 & 61.3 sq.m.
 = 4 x Type 3D @ 53.4 & 61.3 sq.m.
 = Creche.

TOTAL NUMBER OF UNITS = 143
 SITE AREA = 7.79 HECTARES
 DEVELOPABLE SITE AREA = 4.1 HECTARES
 PUBLIC OPEN SPACE = 18.5%
 SITE DENSITY = 143/4.1 = 35 Units / Hectare

Boundary Treatment Key Plan:

- PROPOSED 2m HIGH BLOCK WALL CAPPED (Plastered on Public facing areas)
- PROPOSED DECORATIVE KERB LINE TO DISTINGUISH PROPERTY BOUNDARY
- PROPOSED 2m HIGH CONCRETE POST AND TIMBER PANEL FENCE WITH 300MM CONCRETE BASE PANEL
- PROPOSED 0.8m HIGH BLOCK WALL, CAPPED AND PLASTERED

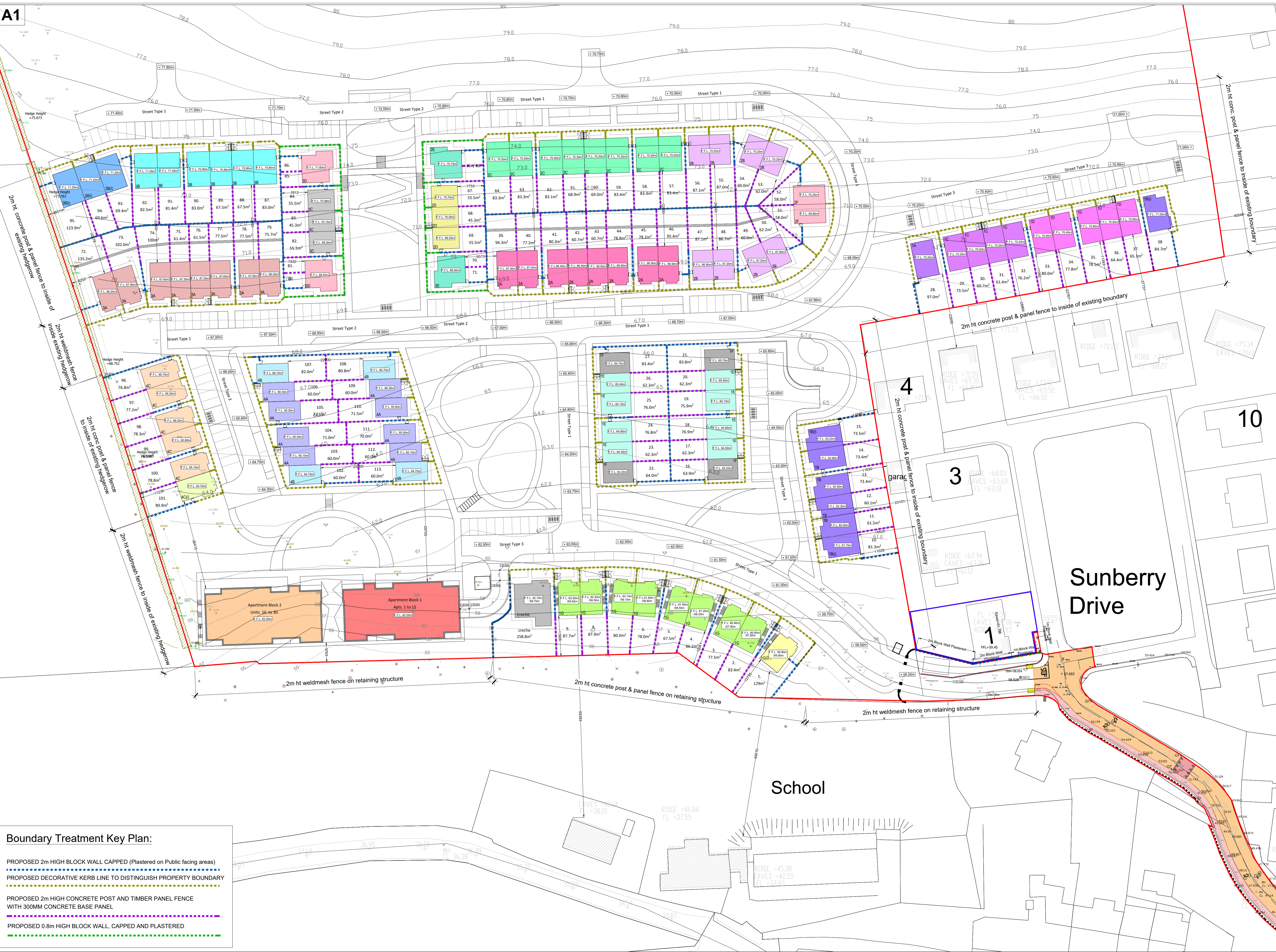

REVISION	DATE
1	21/02/2021
2	07/03/21

BRH
 Design Partners
 Architecture & Engineering

Phoenix House, Monahan Road, Cork.
 T-021 2376150 E: info@brhie

CLIENT: Eoin Sheehan
 PROJECT: Residential Development at Monacnapa, Blarney, Co. Cork
 DRG: Housing Mix and Boundary Treatment

Scale	1:500 on A1
Drawn By	MB
Checked By	MB
Job No.	21_001
Drawing Number	P-08
Revision	2
Stage	PA